



APPLICATION FOR ROAD NAME/S



PLEASE COMPLETE ALL MANDATORY FIELDS* OF THIS FORM.

This form provides contact information and details of your application. If your form does not provide the required information it will be returned to you to complete. Until we receive a completed form and payment of the initial fee, your application will not be accepted for processing.



APPLICANT //

- Must be a person or legal entity (limited liability company or trust).
- Full names of all trustees required.
- The applicant name(s) will be the consent holder(s) responsible for the consent and any associated costs.

*Applicant's Full Name / Company / Trust:
(Name Acceptance is to be issued in)

All trustee names (if applicable):

*Contact name for company or trust:

*Postal Address: *Post code:

*Contact details supplied must be for the applicant and not for an agent acting on their behalf and must include a valid postal address

*Email Address:

*Phone Numbers: Day Mobile:

*The Applicant is:

Owner Prospective Purchaser (of the site to which the application relates)

Occupier



CORRESPONDENCE DETAILS // If you are acting on behalf of the applicant e.g. agent, consultant or architect please fill in your details in this section.

*Name & Company:

*Phone Numbers: Day Mobile:

*Email Address:

*Postal Address: *Postcode:



INVOICING DETAILS //

Invoices will be made out to the applicant but can be sent to another party if paying on the applicant's behalf. For more information regarding payment please refer to the Fees Information section of this form.

*Please select a preference for who should receive any invoices and how they would like to receive them.

Applicant: Agent: Other - Please specify:

Email: Post:

*Attention:

*Postal Address: *Post code:

*Please provide an email AND full postal address.

*Email:



GENERAL INFORMATION

An applicant requesting to use Maori names for roads will be directed to consult with the IWI prior to seeking Council approval ([refer to Road Naming Policy](#)). Upon receipt of the application, staff will consult with the IWI to ensure consultation has occurred.

A list of approved road name is available from QLDC. This list has been compiled by local historic groups and the Council believes they are appropriate names.

HAVE YOU INCLUDED:

A copy of the subdivision plan highlighting the road/s

A location map

Cover Letter advising which section of the road naming policy your application meets and why

Evidence of how name selected meets policy

Affected Party Approval if required

ROAD NAME DETAILS // The Council has requested you must provide three choices for each name

First Choice

Second Choice

Third Choice

Vested OR Private



LEGAL DESCRIPTION OF LAND WHICH ROAD/S IS IN RELATION TO

RESOURCE CONSENT REFERENCE

HOW DOES THE NAMES SELECTED MEET THE ROAD NAMING POLICY - THIS CAN BE INCLUDED IN COVER LETTER

APPLICATION & DECLARATION

The Council relies on the information contained in this application being complete and accurate. The Applicant must take all reasonable steps to ensure that it is complete and accurate and accepts responsibility for information in this application being so.

If lodging this application as the Applicant:

I/we hereby represent and warrant that I am/we are aware of all of my/our obligations arising under this application including, in particular but without limitation, my/our obligation to pay all fees and administrative charges (including debt recovery and legal expenses) payable under this application as referred to within the Fees Information section.

OR:

If lodging this application as agent of the Applicant:

I/we hereby represent and warrant that I am/we are authorised to act as agent of the Applicant in respect of the completion and lodging of this application and that the Applicant / Agent whose details are in the invoicing section is aware of all of his/ her/its obligations arising under this application including, in particular but without limitation, his/her/ its obligation to pay all fees and administrative charges (including debt recovery and legal expenses) payable under this application as referred to within the Fees Information section.

Signed (by or as authorised agent of the Applicant) **

Full name of person lodging this form

Firm/Company

Dated

***If this form is being completed on-line you will not be able, or required, to sign this form and the on-line lodgement will be treated as confirmation of your acknowledgement and acceptance of the above responsibilities and liabilities and that your representations, warranties and certification.*



PRIVACY INFORMATION

The information you have provided on this form is required so that your application can be processed. The information and application documents will be stored on a public register and may be made available to the public on request or on the Council's websites.



ROAD NAMING INITIAL FEE \$243.00



PAYMENT // The initial fee must be paid

I confirm payment by: Bank transfer to account **02 0948 0002000 00** reference **RN#** (If paying from overseas swiftcode – BKNZLN22)

Invoice for initial fee requested and payment to follow

Reference Used:

Initial Fee Required (refer to above): **\$243.00**

Fees as per Resource Consent & Engineering Fees & Other Charges,

Date of Payment:



QUEENSTOWN
LAKES DISTRICT
COUNCIL

Queenstown Lakes District Council
Private Bag 50072, Queenstown 9348
Gorge Road, Queenstown 9300

P: 03 441 0499
E: engineeringapprovals@qldc.govt.nz
www.qldc.govt.nz

Alpine Meadows Road Naming Application:

Road 2A of RM200259

First Choice: Packer McKenzie Road

Second Choice: McKenzie Road

Third Choice: Packer Road

Packer McKenzie was well respected local who worked for many years on the land to be subdivided through RM200259.

Road 3 of RM200259

First Choice: Buttercup Street

Second Choice: O'Sullivan Street

Buttercup is a flower variety commonly found on Alpine meadowland such as the application site.

O'Sullivan is a name from the current QLDC approved names list.

Road 4A of RM200259

First Choice: Alpine Meadows Drive

Second Choice: Long Meadow Drive

Third Choice: Meadows Drive

Historically the land subject to the subdivision was never very productive and never well irrigated so it was a meadowy paddock. The subdivision has been named Alpine Meadows for this reason. The road name Alpine Meadows Drive reflects this. The second choice of Long Meadow is another literal name because the meadow extends to Orchard Road.

Road 5 of RM200259

First Choice: Sybil McPherson Drive

Second Choice: McPherson Drive

Third Choice: Sybil Drive

Sybil McPherson was the wife of Bill McPherson, who was manager of the Wanaka Station Farm (of which the application site formed part of) from 1946. Sybil did a lot of good for the community and also lived near to the application site.

Road 9A of RM200259

First Choice: Ensor Street

Second Choice: Dick Ensor Street

Third Choice: Peasgood Drive

Dick Ensor was a young man that worked for the Gordons when they owned the farm. Dick became a notable character in Wanaka until he lost his life in a chainsaw accident.

Peasgood English Heritage Variety apple reflecting the orchard across the road that Road 9A leads to.

From: Alison Devlin
To: Charlie Evans
Cc: Alan Dingle
Subject: RE: Road Naming Acknowledgement - Orchard Road Holdings Limited (RN240012)
Date: Friday, 27 September 2024 9:31:45 AM
Attachments:

Hi Charlie,

We can't find any more information on this other than what Dee Gordon has told us. We could put you in touch with Dee for you to talk to her about these people if that would help?

Kind regards,

Alison.

From: Charlie Evans <Charlie.Evans@qldc.govt.nz>
Sent: Thursday, 12 September 2024 12:15 pm
To: Alison Devlin <alison@WILLOWRIDGE.CO.NZ>
Subject: RE: Road Naming Acknowledgement - Orchard Road Holdings Limited (RN240012)

Thanks Alison,

As per the policy can you please provide evidence of your statement below:

We can confirm that all are deceased (not recently deceased).

Also do you have any evidence confirming the below statements i.e. obituary notice.

Packer McKenzie was well respected local who worked for many years on the land to be subdivided through RM200259.

Sybil McPherson was the wife of Bill McPherson, who was manager of the Wanaka Station Farm (of which the application site formed part of) from 1946. Sybil did a lot of good for the community and also lived near to the application site.

Dick Ensor was a young man that worked for the Gordons when they owned the farm. Dick became a notable character in Wanaka until he lost his life in a chainsaw accident.

Kind Regards

Charlie

Charlie Evans | Senior P&D Technical Officer | Planning & Development
Queenstown Lakes District Council
DD: +64 3 450 0355 | P: +64 3 441 0499
charlie.evans@qldc.govt.nz



From: Alison Devlin <alison@WILLOWRIDGE.CO.NZ>
Sent: Monday, September 9, 2024 2:33 PM
To: Charlie Evans <Charlie.Evans@qldc.govt.nz>
Subject: RE: Road Naming Acknowledgement - Orchard Road Holdings Limited (RN240012)

Hi Charlie,

Apparently there are no living relatives and the information we provided is all that we have on the names.

We can confirm that all are deceased (not recently deceased).

Kind regards,

Alison.

From: Charlie Evans <Charlie.Evans@qldc.govt.nz>
Sent: Friday, 6 September 2024 10:01 am
To: Alison Devlin <alison@WILLOWRIDGE.CO.NZ>
Subject: Road Naming Acknowledgement - Orchard Road Holdings Limited (RN240012)

Good morning,

Thank you for your road naming application.

Your application has been received.

As discussed in relation to your application, can you please provide evidence in relation to the options for the names you have put forward i.e. historical information confirming the Packer McKenzie was a local and also it would be great if we could have approval from the families confirming they would be happy with their names being used.

I can confirm that we have received payment for the initial fee as per below:

RBR0244511	26-Aug-2024	\$243.00	"Orchard Rd H","Deposit","RN200259","Orchard Road","26/08/2024 12:00:00 AM","02-0912-0299500-00"
------------	-------------	----------	--

Kind Regards

Charlie

Charlie Evans | Senior P&D Technical Officer | Planning & Development
Queenstown Lakes District Council
DD: +64 3 450 0355 | P: +64 3 441 0499
charlie.evans@qldc.govt.nz

From: Alison Devlin <alison@WILLOWRIDGE.CO.NZ>
Sent: Monday, August 26, 2024 11:51 AM
To: Engineering Approval Applications <Engineeringapprovals@qldc.govt.nz>
Cc: Charlie Evans <Charlie.Evans@qldc.govt.nz>

Subject: Road Naming Application

Hi Charlie,

Please find attached road naming application. The deposit should be paid today.

Kind regards,

Alison.

Alison Devlin (BA(Hons), MSc, MRTPI)
General Manager
03 474 9911 ext 4/ 021 969 152



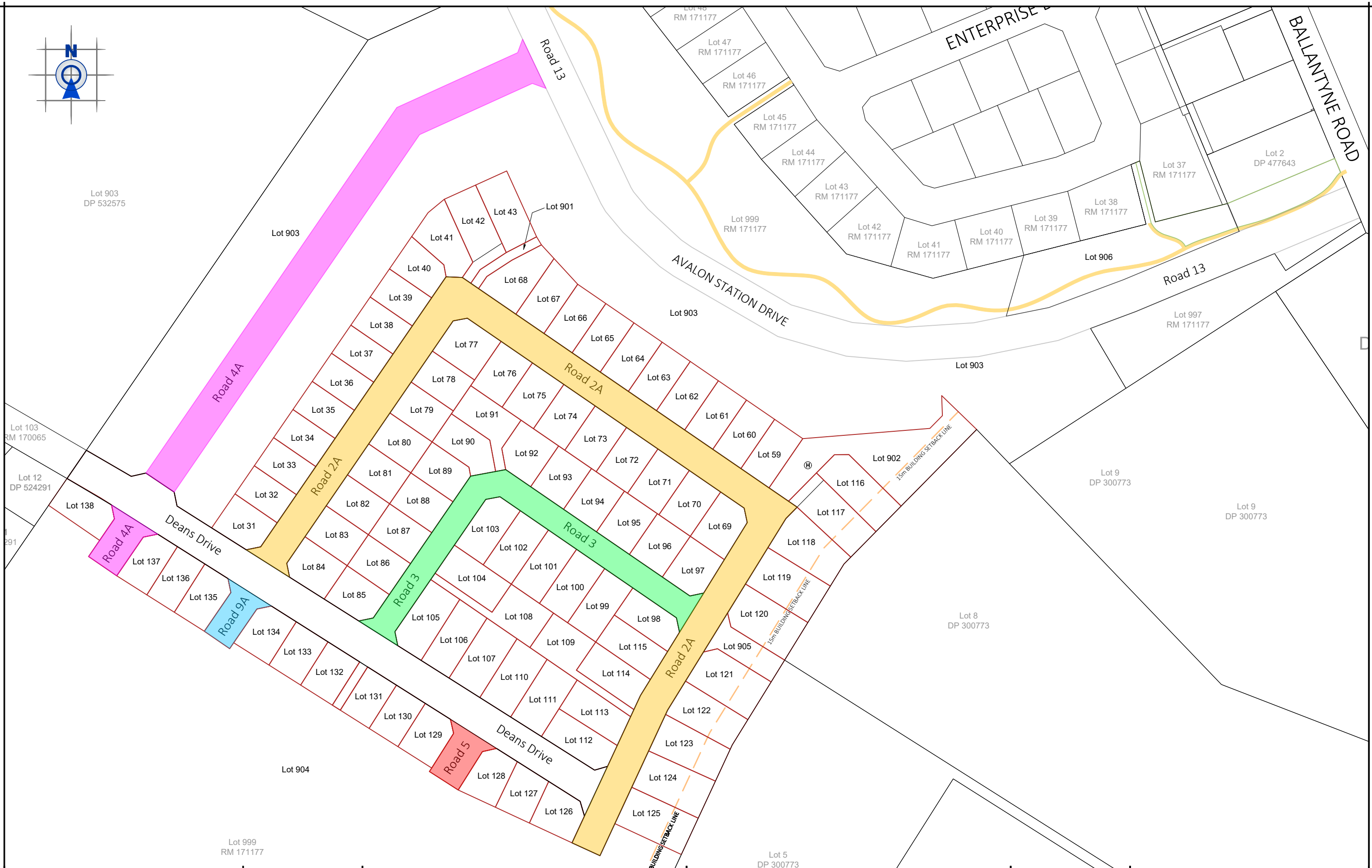

PATERSONPITTSGROUP
 Your Land Professionals
 www.ppgroup.co.nz
 0800 PPGROUP

WANAKA BRANCH
 19 Reece Crescent
 or P.O. Box 283
 Wanaka 9343
 T 03 443 0110
 E wanaka@ppgroup.co.nz

Client & Location:
Orchard Road Holdings Ltd
Alpine Meadows Stage 1
Wanaka

Purpose & Drawing Title:
Road Name Plan

© COPYRIGHT. This drawing, content and design remains the property of Paterson Pitts Limited Partnership and may not be reproduced in part or full or altered without the written permission of Paterson Pitts Limited Partnership. This drawing and its content shall only be used for the purpose for which it is intended. No liability shall be accepted by Paterson Pitts Limited Partnership for its unauthorized use.

Surveyed by:	---	Original Size:	A3	Scale:	1:2000 @ A3
Designed by:	PPG				
Drawn by:	TMM/BJK				
Checked by:	SJD				
Approved by:	SJD				DO NOT SCALE
Job No:	W5620	Dwg No:	008	Sheet No:	100
				Revision No:	3
				Date Created:	24/10/2024



Roading Schedule		
Name	Legal Width	Carriageway Width
Road 1	20.00m	8.40m
Road 2A	18.00m	5.70m
Road 2B	18.00m	5.70m
Road 3	15.00m	5.70m
Road 4A	20.00m	8.40m
Road 4B	20.00m	8.40m
Road 5	20.00m	5.70m
Road 6A	18.00m	5.70m
Road 6B	18.00m	5.70m
Road 7	18.00m	5.70m
Road 8	18.00m	5.70m
Road 9A	18.00m	5.70m
Road 9B	18.00m	5.70m
Road 10	18.00m	5.70m
Road 11	15.00m	5.70m
Road 12	15.00m	5.70m
Road 13	20.00m	8.40m

For Resource Consent

PATERSONPITTSGROUP
 Your Land Professionals
 www.ppgroup.co.nz
 0800 PPGROUP

WANAKA BRANCH
 19 Reece Crescent
 or P.O. Box 283
 Wanaka 9343
 T 03 443 0110
 E wanaka@ppgroup.co.nz

Client & Location:
Orchard Road Holdings Ltd
Alpine Meadows Stage 1
Wanaka

Purpose & Drawing Title:
Scheme Plan
Lots 31-43, 59-138, 900-906
Being a Subdivision of
Lot 999 DP 535926

© COPYRIGHT. This drawing, content and design remains the property of Paterson Pitts Limited Partnership and may not be reproduced in part or full or altered without the written permission of Paterson Pitts Limited Partnership. This drawing and its content shall only be used for the purpose for which it is intended. No liability shall be accepted by Paterson Pitts Limited Partnership for its unauthorized use.

Surveyed by:	TMM	Original Size: A3	Scale: 1:4000 @ A3
Designed by:	TMM		
Drawn by:	TMM		
Checked by:	SJD		
Approved by:	SJD	DO NOT SCALE	
Job No:	W5620	Sheet No: 100a	Revision No: C
Dwg No:	002		Date Created: 16/08/2019