

KEY:

- Site Boundary
- Proposed Scheme Plan Boundaries
- Existing Easements
- District Plan Zones
- QLDC Building Restriction Area
- QLDC Visitor Accommodation Sub-Zone
- Existing House Location

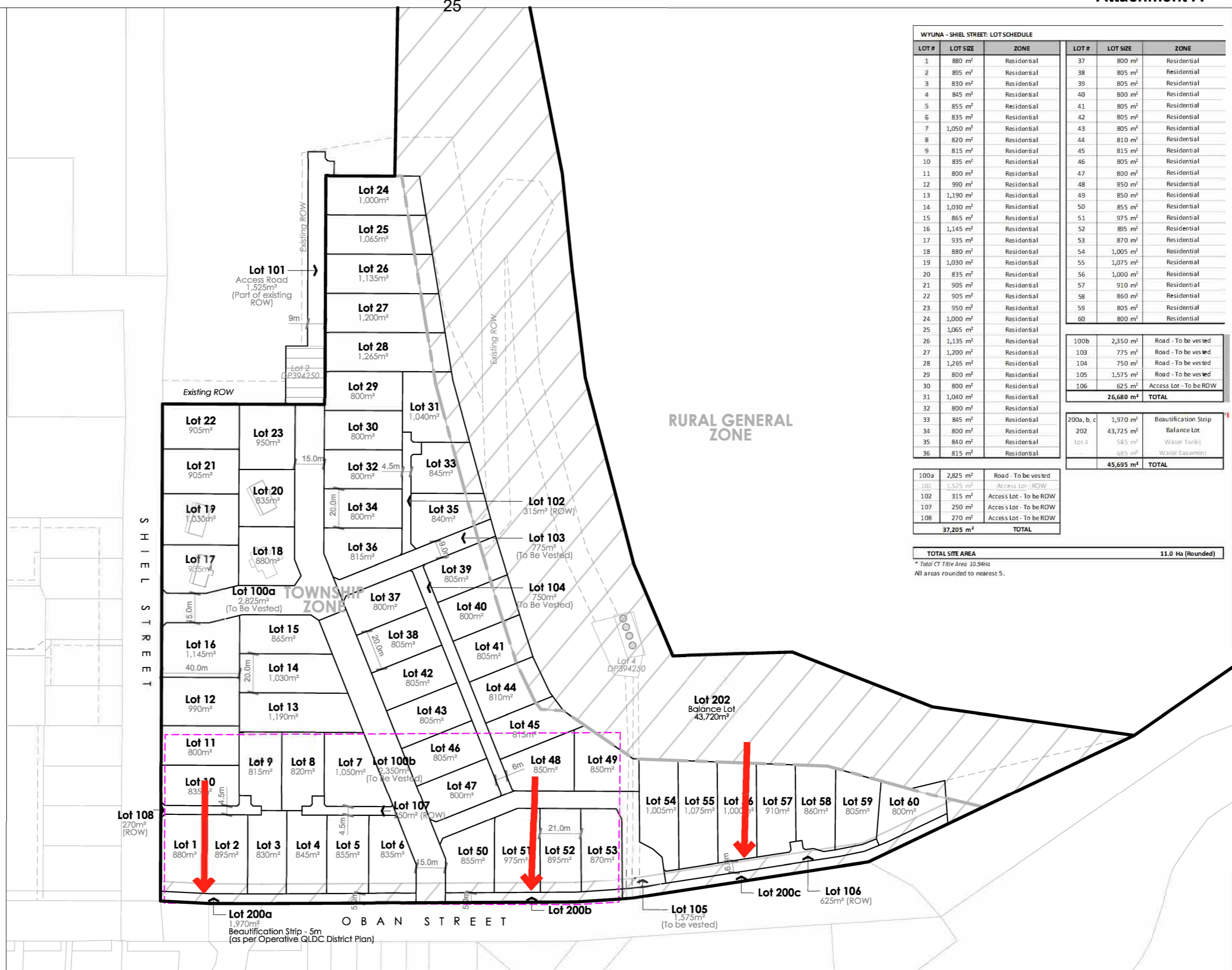

WYUNA - SHIEL STREET: LOT SCHEDULE					
LOT #	LOT SIZE	ZONE	LOT #	LOT SIZE	ZONE
1	880 m ²	Residential	37	800 m ²	Residential
2	895 m ²	Residential	38	805 m ²	Residential
3	830 m ²	Residential	39	805 m ²	Residential
4	845 m ²	Residential	40	800 m ²	Residential
5	855 m ²	Residential	41	805 m ²	Residential
6	835 m ²	Residential	42	805 m ²	Residential
7	1,050 m ²	Residential	43	805 m ²	Residential
8	820 m ²	Residential	44	810 m ²	Residential
9	815 m ²	Residential	45	815 m ²	Residential
10	835 m ²	Residential	46	805 m ²	Residential
11	800 m ²	Residential	47	800 m ²	Residential
12	990 m ²	Residential	48	850 m ²	Residential
13	1,190 m ²	Residential	49	850 m ²	Residential
14	1,030 m ²	Residential	50	855 m ²	Residential
15	865 m ²	Residential	51	975 m ²	Residential
16	1,145 m ²	Residential	52	895 m ²	Residential
17	935 m ²	Residential	53	870 m ²	Residential
18	880 m ²	Residential	54	1,005 m ²	Residential
19	1,030 m ²	Residential	55	1,075 m ²	Residential
20	835 m ²	Residential	56	1,000 m ²	Residential
21	905 m ²	Residential	57	910 m ²	Residential
22	905 m ²	Residential	58	860 m ²	Residential
23	950 m ²	Residential	59	805 m ²	Residential
24	1,000 m ²	Residential	60	800 m ²	Residential
25	1,065 m ²	Residential			
26	1,135 m ²	Residential			
27	1,200 m ²	Residential			
28	1,265 m ²	Residential			
29	800 m ²	Residential			
30	800 m ²	Residential			
31	1,040 m ²	Residential			
32	800 m ²	Residential			
33	845 m ²	Residential			
34	800 m ²	Residential			
35	840 m ²	Residential			
36	815 m ²	Residential			
100b	2,350 m ²	Road - To be vested			
103	775 m ²	Road - To be vested			
104	750 m ²	Road - To be vested			
105	1,575 m ²	Road - To be vested			
106	625 m ²	Access Lot - To be ROW			
			26,680 m²	TOTAL	
200a, b, c	1,970 m ²	Beautification Strip			
202	43,720 m ²	Balance Lot			
Lot 4	585 m ²	Water Tank			
	685 m ²	Water Easement			
			45,695 m²	TOTAL	

100a	2,825 m ²	Road - To be vested
101	1,525 m ²	Access Lot - ROW
102	315 m ²	Access Lot - To be ROW
107	250 m ²	Access Lot - To be ROW
108	270 m ²	Access Lot - To be ROW
37,205 m²		TOTAL

TOTAL SITE AREA **11.0 Ha (Rounded)**
 * Total CT Title Area 10.94Ha
 All areas rounded to nearest 5.

V:\WS - Wyuna\11_Bible Terrace\2_Consents\WS_11_2_RC-001.G (Proposed Scheme Plan - RFI).dgn

RFI

DARBY PARTNERS
 Level 1, Steamer Wharf, Lower Beach Street
 PO Box 1164, Queenstown 93 48
 Tel +64 3 450 2200 Fax +64 3 441 1451
 info@darbypartners.co.nz
 www.darbypartners.co.nz



NOTE:
 All boundaries and areas are subject to survey

REVISION:	NO.	DESCRIPTION	DATE	DRAWN	REVIEWED	APPROVED
-		For Resource Consent	30.08.17	MM	TG	DT
A		Lot 200 numbering	31.08.17	MM	-	-
B		Road Layout update	12.09.17	MM	-	-
C		Schedule update	15.09.17	MM	-	-
D		Lot 200 numbering	21.09.17	MM	-	-
E		Lot 200 numbering	10.10.17	MM	TG	-
F		RFI - Road layout update	01.03.18	MM	-	-
G		RFI - Road layout update	17.04.18	HG/MM	-	-

WYUNA SHIEL STREET SUBDIVISION SCHEME PLAN

PLAN STATUS: **RFI** JOB CODE: **WS_11_2** DRAWING NO: **RC-001** REV: **G**