

Site Masterplan

68 Sections Total

- Higher Density Scheme
- Smaller Section Sizes
- High proportion of 3 Bed, Semi-Detached units to maximise beds
- Could include more 2 bed terraces if a mix/variety is preferred
- Houses in cul-de-sac and lane different cladding to differentiate smaller communities/neighbourhoods within the larger development

Possible Roading Layout

- 15m wide (based on width from initial masterplan)
- Shared pedestrian/cycle/vehicle space
- Parking Lane

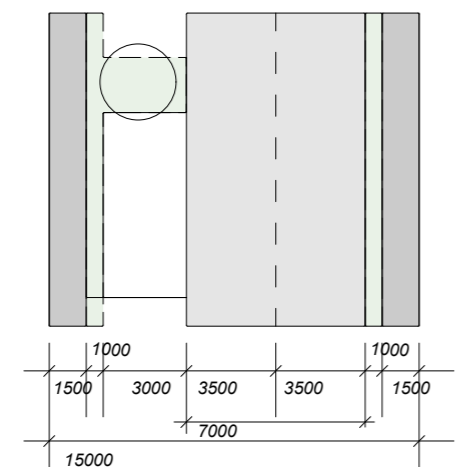

Roading Hatch

- Shared Surface Transition
- Footpath
- Green Berm
- Road
- Parking Lane

Minimise separation between various road users; cars, pedestrians, cyclists
Encourage lower speeds & less car dominance

No.	Typology	Features
x6	Type 1 - Standalone/Duplex 1 x Bed, Single Storey	
x20	Type 2 - Standalone/Duplex 2 x Bed, Single Storey	
x16	Type 3 - Standalone 3 x Bed, Single Storey	
x20	Type 4 - Standalone/Duplex/Terrace 3 x Bed, Double Storey	
x6	Type 5 - Duplex 4 x Bed Double Storey	

JOPP STREET

ISABEL COURT

INNES PLACE

ARROWTOWN GOLF COURSE

Revision

Site

Wind zone	Very High
Exposure zone	Zone B
Earthquake zone	Zone 3

Project

Job number	1111
Drawn	KP
Approved	MD

Check all dimensions on site
Do not scale from plans
If in doubt consult the architect
Read in conjunction with the architectural specification and all consultant documentation

Name and address

Tewa Banks

Jopp Street, Arrowtown, 9302.

Drawing

Concept Masterplan

Status

For Information

Number Revision

1

A3 Drawing



Site Overview From the West



View From the North East Corner

Revision

Site	
Wind zone	Very High
Exposure zone	Zone B
Earthquake zone	Zone 3

Project	
Job number	1111
Drawn	KP
Approved	MD

Check all dimensions on site
Do not scale from plans
If in doubt consult the architect
Read in conjunction with the architectural
specification and all consultant documentation

Name and address

Tewa Banks
Jopp Street, Arrowtown, 9302.

Drawing

3D Perspectives

Status

For Information

Number	Revision
--------	----------

2

Revision

Site

Wind zone	Very High
Exposure zone	Zone B
Earthquake zone	Zone 3

Project

Job number	1111
Drawn	KP
Approved	MD

Check all dimensions on site
Do not scale from plans
If in doubt consult the architect
Read in conjunction with the architectural
specification and all consultant documentation

Name and address

Tewa Banks
Jopp Street, Arrowtown, 9302.

Drawing

3D Perspectives

Status

For Information

Number Revision

3



View Towards Cul-de-sac



View From the South West Corner